

SOUTH HOUGHTON ROAD WIDENING

Project 4SHRWD

SERC Meeting

January 28, 2021

The logo for PSOMAS, consisting of the letters P, S, O, M, A, S in white, spaced out, on a dark blue square background.

PSOMAS

The logo for Borderland, featuring the word "Borderland" in a bold, yellow, stylized font with a red outline, set against a dark blue background.

Borderland

- Introductions
 - Project Owner/Administrator: Pima County DOT – Mandley Rust, Project Manager
 - Engineering Design Consultant: Psomas – Sean Samsel, Project Manager
 - Construction Manager At-Risk (CMAR): Borderland Construction – Joel Harris, Project Manager
- Project Overview
 - Design and Construction Schedule
 - Major Design Elements
- Comments/Questions?



- **Purpose of Project:**
 - Widen Houghton Road for 3 miles south of I-10 to increase traffic capacity and operations due to projected growth in project area and development of the South East Logistics Center (SELC).
- Project is funded by Southwest Area Impact Fees
- **Project Limits:**
 - North End: Connect to new Houghton I-10 Interchange currently being constructed by ADOT
 - South End: Connect to existing 2-lane road at Pantano/Andrada High Schools
 - Reconstruct intersections at Brekke Road and Dawn Road

- Project design began in Summer 2020
- Design ~50% complete - scheduled to finish Summer 2021
- Utility relocations to begin in Spring 2021
- Construction to begin Spring/Summer 2021
- ~18-month construction duration - completion by end of 2022

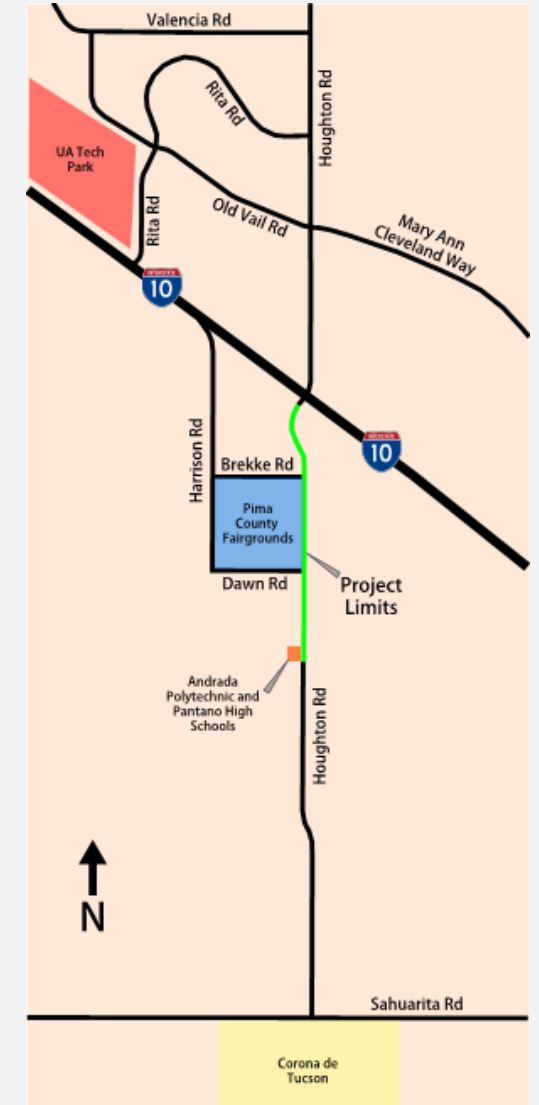

- Roadway Improvements
 - 200' Right-of-Way width
 - Widen to 4 travel lanes with curbed median
 - Paved shoulders in both directions
 - Multi-Use Path (12') on west side

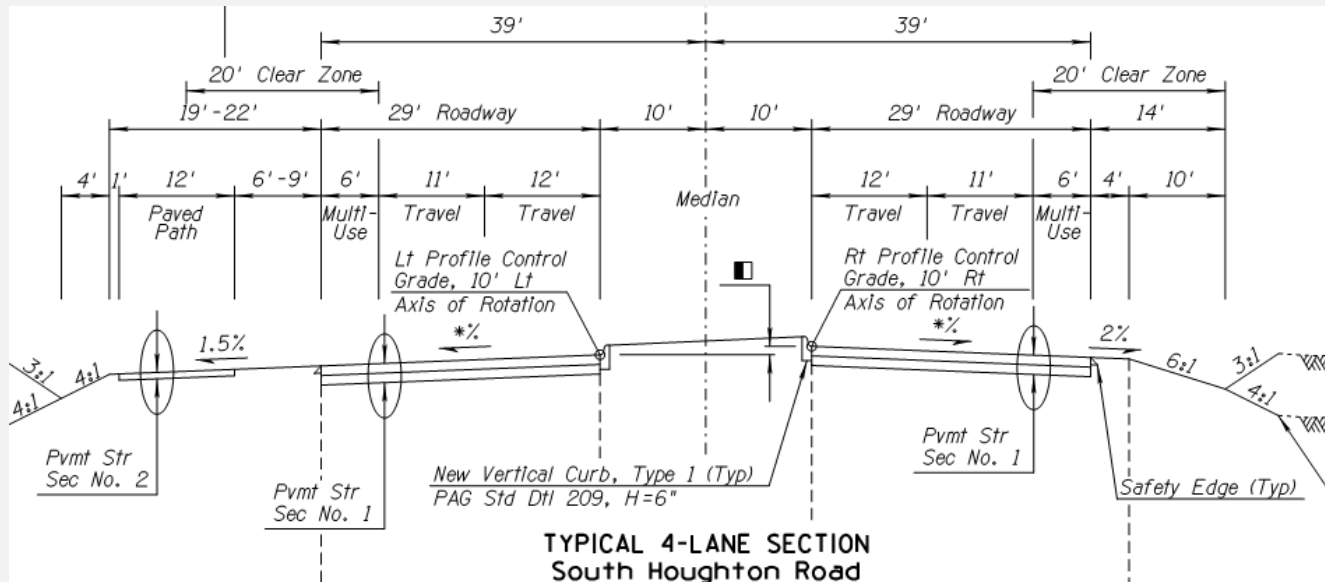

- Intersection and Median Improvements
 - Median openings at ½ mile spacing with turn bays at major intersections and driveways
 - Traffic Signal at Brekke Road
 - Two-stage Left at Dawn Road
 - Unsignalized Florida T at Andrada HS

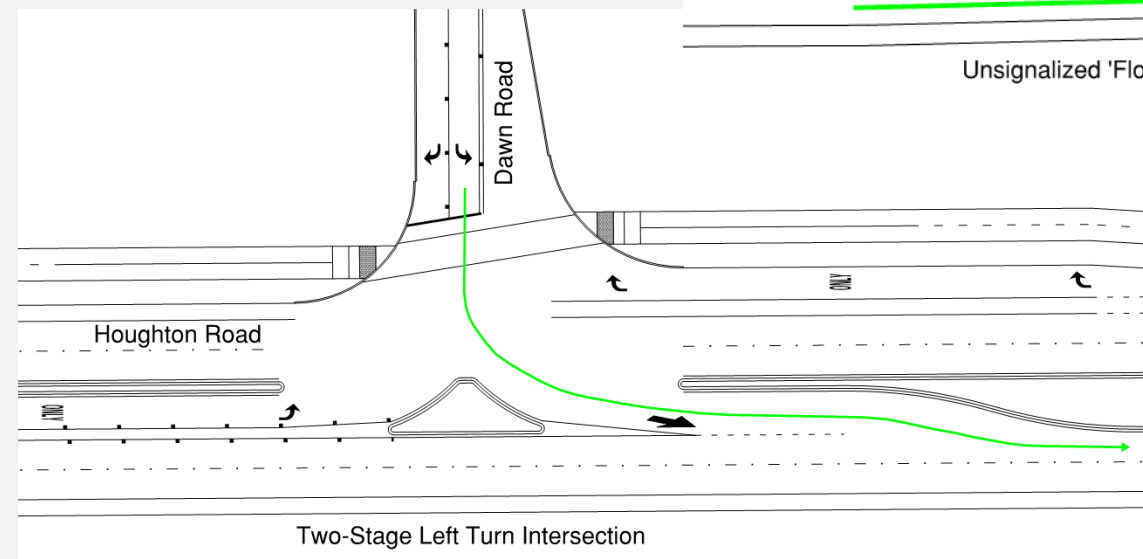
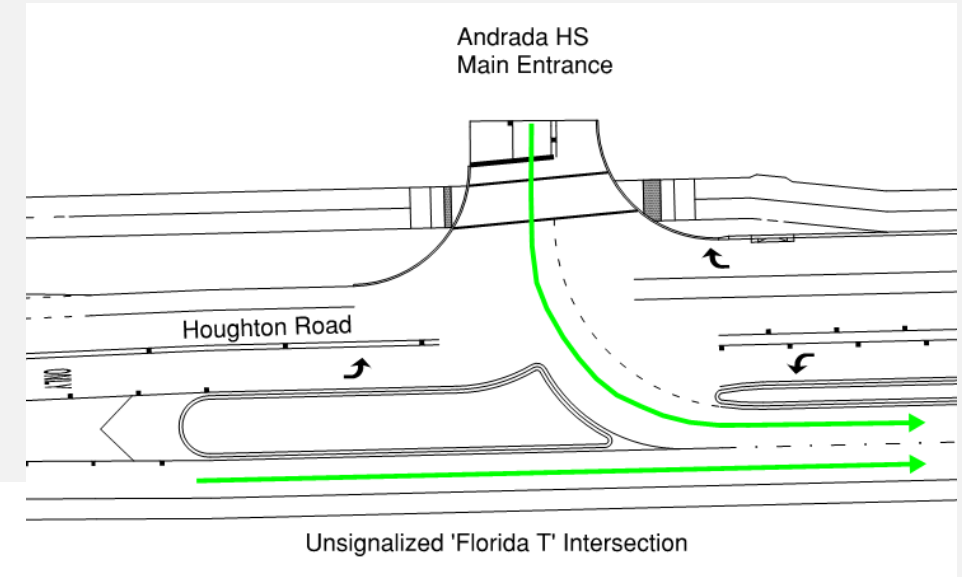

- Drainage Improvements
 - Raised roadway profile to pass 100-year storm event under roadway
 - 24 new pipe and box culverts
 - Upstream collector channels along east side of roadway
 - Downstream channelization through Fairgrounds



- Other Elements
 - Landscape design using native plant palette and water harvesting
- Public Art
- Lighting at Brekke Road, Dawn Road, and Fairgrounds Main Entrance



Comments/Questions?

PSOMAS



Borderland